



EN 13229

BlmSchV Stufe 2

Regensburger BStV / Aachener BStV / Munchener BStV

LRV

4 stelle DM.186 / Conto Termico 2.0

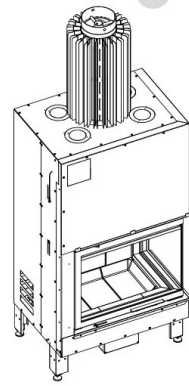
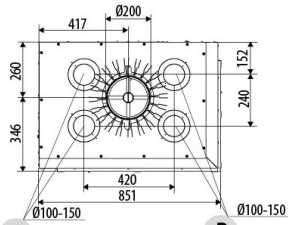
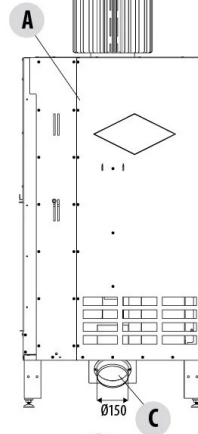
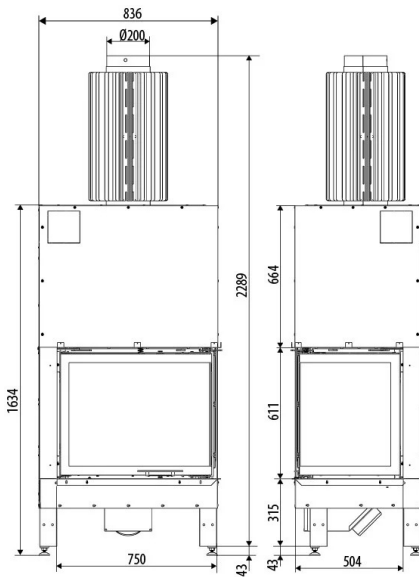

A SEMITRANCIO VENTILAZIONE NATURALE

B SEMITRANCIO Ø100-150

C INGRESSO ARIA COMBURENTE Ø 150

(Max) nominal heat output	13 kW
Minimum heat output	6.6 kW
Efficiency at Max	85.2 %
Efficiency at Min	80.8 %
Energy Efficiency Class (A++ / G scale)	A+
Energy Efficiency Index (EEI)	114 %
Seasonal space heating energy efficiency (ηs)	75 %
Temperature of exhaust smoke at Max	191 °C
Temperature of exhaust smoke at Min	221 °C
Particulate/OGC / Nox (nominal at 13%O2)	13 - 34 - 96 mg/Nm3
CO at 13% O₂ at Min and at Max	0.116 - 0.082 %
CO₂ at Min and at Max	7.6 - 8.7 %
Mass of smoke at Min and at Max	7 - 11.5 g/sec
Fuel dimensions	L 250 ÷ 330mm
Hourly consumption at Min and at Max	1.9 - 3.5 kg/h *
Heatable volume m3	236 - 371 - 650 **
Combustion air inlet	Ø 150 mm
Air inlet	180 cm2
Smoke outlet	Ø 200 mm
Net weight	361 kg
Distance from combustible material (back/side/under)	160 mm / 160 mm / 220 mm
Distance from combustible material (front/ceiling)	800 mm / 1000 mm

* Data that may vary depending on the type of pellets used.

**Heatable volume based on the requested power per m3 (respectively 55-35-20 W/m3)